

FIRST FLOOR PLUMBING PLAN - UNIT 2
3/16" = 1'-0"

THIS DRAWING SHEET IS INTENDED TO BE PLOTTED IN COLOR. IF THIS TEXT APPEARS IN BLACK AND WHITE, IT IS PLOTTED INCORRECTLY. DISCARD AND OBTAIN AN ACCURATE DRAWING

KEYED NOTES - PLUMBING - DOMESTIC

- COORDINATE WITH CIVIL AND PROPANE TANK GAS PROVIDER FOR CONNECTING INTO AND RESIZING EXISTING BURIED PROPANE TANK PIPING AND ACCESSORIES.
- CONDENSATE LINE 1" A.G. THRU WALL WITH TURN DOWN ELBOW AND INSECT SCREEN. CORE DRILL 3" DIA. HOLE THROUGH CONCRETE WALKWAY BELOW CONDENSATE DRAIN AND FILL WITH 12" GRAVEL.

TowerPinkster
Architecture - Engineering - Interiors

Risepointe
architecture • design • interiors
1520 MEADOWS STREET
SEATTLE, WA 98103
206.441.4400

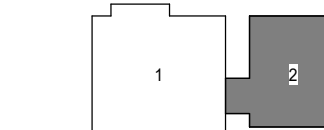

ARCHITECTURE

Risepointe

CONTACT: CHRIS STRASSER

200 N. HARRISON ST. UNIT 101

ALCOCK, AL. 90102

P. 202.381.8171

WWW.RISEPOINTE.COM

GENERAL CONTRACTOR

A.R. CHESON

CONTACT: CHRIS MORRIS

136 E. RICH BLVD.

ELIZABETH CITY, NC 27801

P. 202.381.8171

WWW.ARCHESON.COM

CIVIL ENGINEERING

EASTERN CAROLINA CONSTRUCTION

CONTACT: BRIAN ROBERT

154 US HWY 101 E.

CANDLER, NC 27801

P. 202.821.3575

WWW.EASTERNCAROLINAENGINEERING.COM

STRUCTURAL

TOWER PINKSTER

CONTACT: BAILEY RAHLER

4 FULTON ST. E. 4000

GRAND RAPIDS, MI 49503

P. 616.794.6225

WWW.TOWERPINKSTER.COM

MECHANICAL

TOWER PINKSTER

CONTACT: DENVER WESSELS

4 FULTON ST. E. 4000

GRAND RAPIDS, MI 49503

P. 616.794.6225

WWW.TOWERPINKSTER.COM

ELECTRICAL

TOWER PINKSTER

CONTACT: GUYMON NICKELSON

4 FULTON ST. E. 4000

GRAND RAPIDS, MI 49503

P. 616.794.6225

WWW.TOWERPINKSTER.COM

PLUMBING

TOWER PINKSTER

CONTACT: DENVER WESSELS

4 FULTON ST. E. 4000

GRAND RAPIDS, MI 49503

P. 616.794.6225

WWW.TOWERPINKSTER.COM

AUDIO - VIDEO - LIGHTING - ACOUSTICS

LIVESPACE

CONTACT: JONAH HENRY

4600 STARR ST. SE

GRAND RAPIDS, MI 49506

P. 616.777.8547

WWW.LIVESPACE.COM

INFORMATION TECHNOLOGY

INTULISE

CONTACT: CHRIS STEB

151 FORBES DR.

LANCASTER, PA 17601

P. 717.796.5382

WWW.INTULISE.COM

PROJECT NAME

TOWNE SOUTH CHURCH

2224 PEARTREE RD.

ELIZABETH CITY, NC 27909

CURRENT ISSUE

ISSUED FOR R/W CD

2025.04.30

SHEET NAME

FIRST FLOOR PLUMBING

PLAN - UNIT 2

PROJECT NUMBER

25-623

SCALE

3/16" = 1'-0"

DRAWING NUMBER

P-112

PROJECT DATE

2025.04.30

ISSUED FOR PERMIT

2025.04.30

ISSUED FOR R/W CD

2025.04.30

PROJECT NUMBER

25-623

SCALE

3/16" = 1'-0"

DRAWING NUMBER

P-112